

# WAY TO GO LED FLOOD



Power Supply



MEANWELL MADE IN TAI

Dimension: 600 LX285 WX 93 H mm



## Application

Building Exteriors, parking lots, tunnels, underground passage, railway, , and yard lighting

Models	<b>WTG-:</b> 10w,20w,50w 100w, 120w, 150w,
Power	120-277V OR 347-480v
Frequency Range	50/60Hz
Inrush Current	30A@ 220Vac Input ; Cold start
Current Rating	0.8A
Power Factor	0.95
LED Type	Cree XML T6
Led Luminous Efficiency	73 Lm/W
Color Temperature	3000, 4,000, 6000k
Color Rendering Index	Ra > 75
Beam angle	45°/90°/120°
IP Rating	65
Working Temperature	-29°C ~ +40°C
Working Life-span 70%	50,000H

# Luminance Distributions

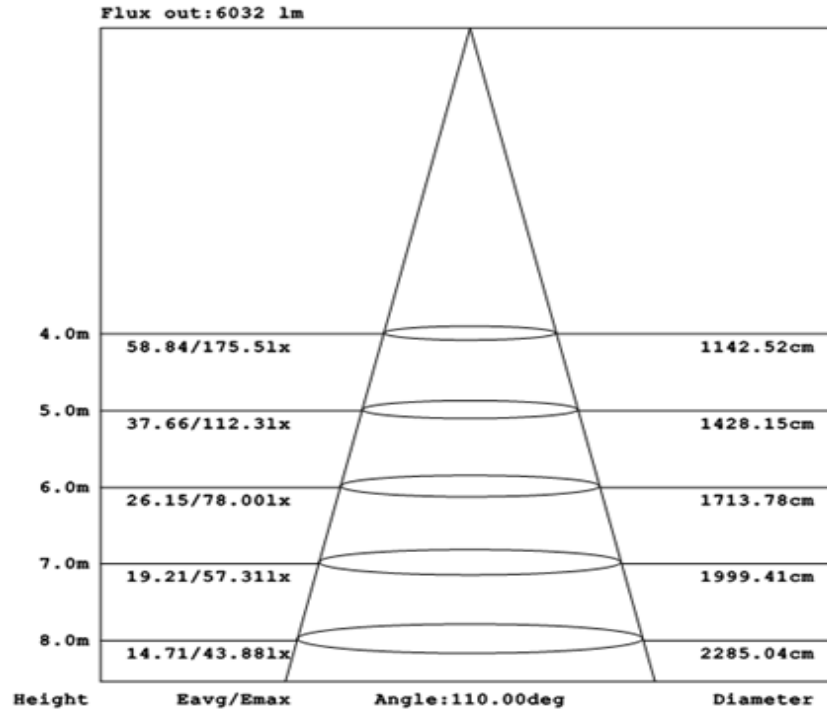

# Wiring & Installation

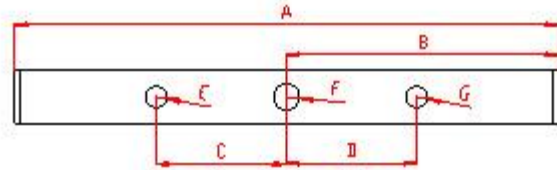
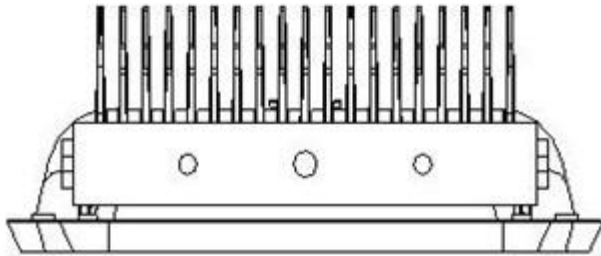

After connecting wire based on the picture, the point of connection must be put in water-proof box.

